

FRONT VIEW

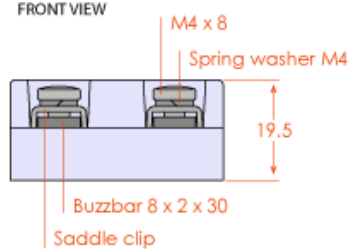

SECTION A-A

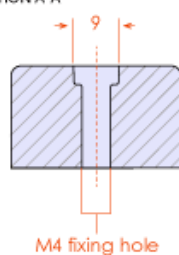

TOP VIEW

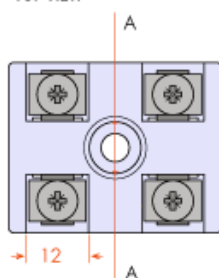

BOTTOM VIEW

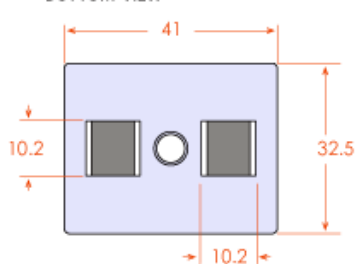

Maximum voltage: 500V
 Maximum temperature: 450°C / 842°F
 Maximum current: 20A*
 Maximum cable CSA (solid): 4.0mm sq.
 Maximum cable CSA (stranded/with ferrule): 2.5mm sq.

*Up to 30A permissible at lower temperatures,

2P CERAMIC TERMINAL BLOCK

02.08.17

*All dimensions are mm, post firing (final dimensions)

*All dimensions specified on ceramic material have a tolerance of +/- 3%.



HOLLAND INFRAROOD TECHNIEK B.V.
RADIANT HEATING SYSTEMS